

# DensShield® Tile Backer

## Steel-Framed Wall

5/8" (15.9 mm) **DensShield® Tile Backer** or 5/8" (15.9 mm) **ToughRock® Fireguard®** or 5/8" (15.9 mm) **DensArmor Plus® Fireguard®** gypsum board applied vertically to each side of 3-5/8" (92 mm) steel studs 24" (610 mm) o.c. with 1" (25 mm) Type S drywall screws 6" (152 mm) o.c. at edges and intermediate studs.

**Sound Tested** with 3" (76 mm) mineral fiber, 2.5 pcf (40.1 kg/m<sup>3</sup>), in stud space.

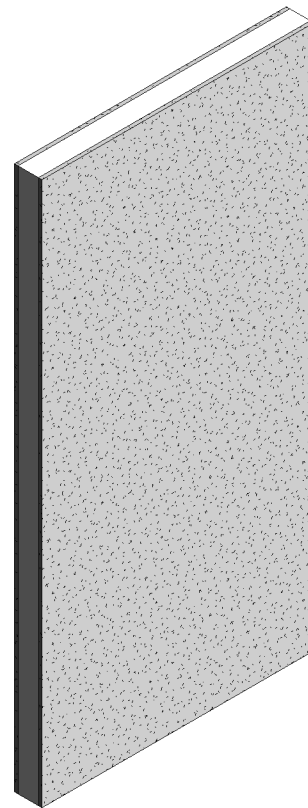
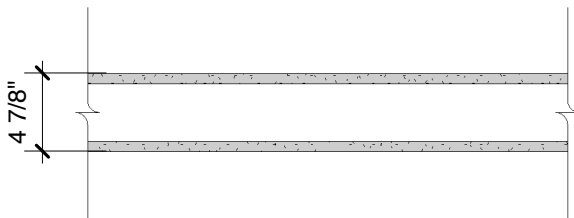

  
**Georgia-Pacific**  
 Gypsum  
 Website: [www.gpgypsum.com](http://www.gpgypsum.com)

**Georgia-Pacific  
 Gypsum**  
 133 Peachtree St.  
 Atlanta, Georgia 30303  
 PH: 1-(800)-225-6119

### DensShield® Tile Backer

Assembly:	U465-03	UL U465
Date:	December 2012	
Drawn by:	JAT	
Checked by:	RSS	Fire Rating: 1 Hr