

GEORGIA-PACIFIC GYPSUM, LLC IS PROVIDING THIS DETAIL AS A SERVICE TO OUR CUSTOMERS. PLEASE OBTAIN APPROVAL FROM THE PROJECT'S ARCHITECT, ENGINEER OR OTHER DESIGN AUTHORITY AND REVIEW WITH LOCAL BUILDING CODE OFFICIALS BEFORE YOU IMPLEMENT THIS DETAIL.

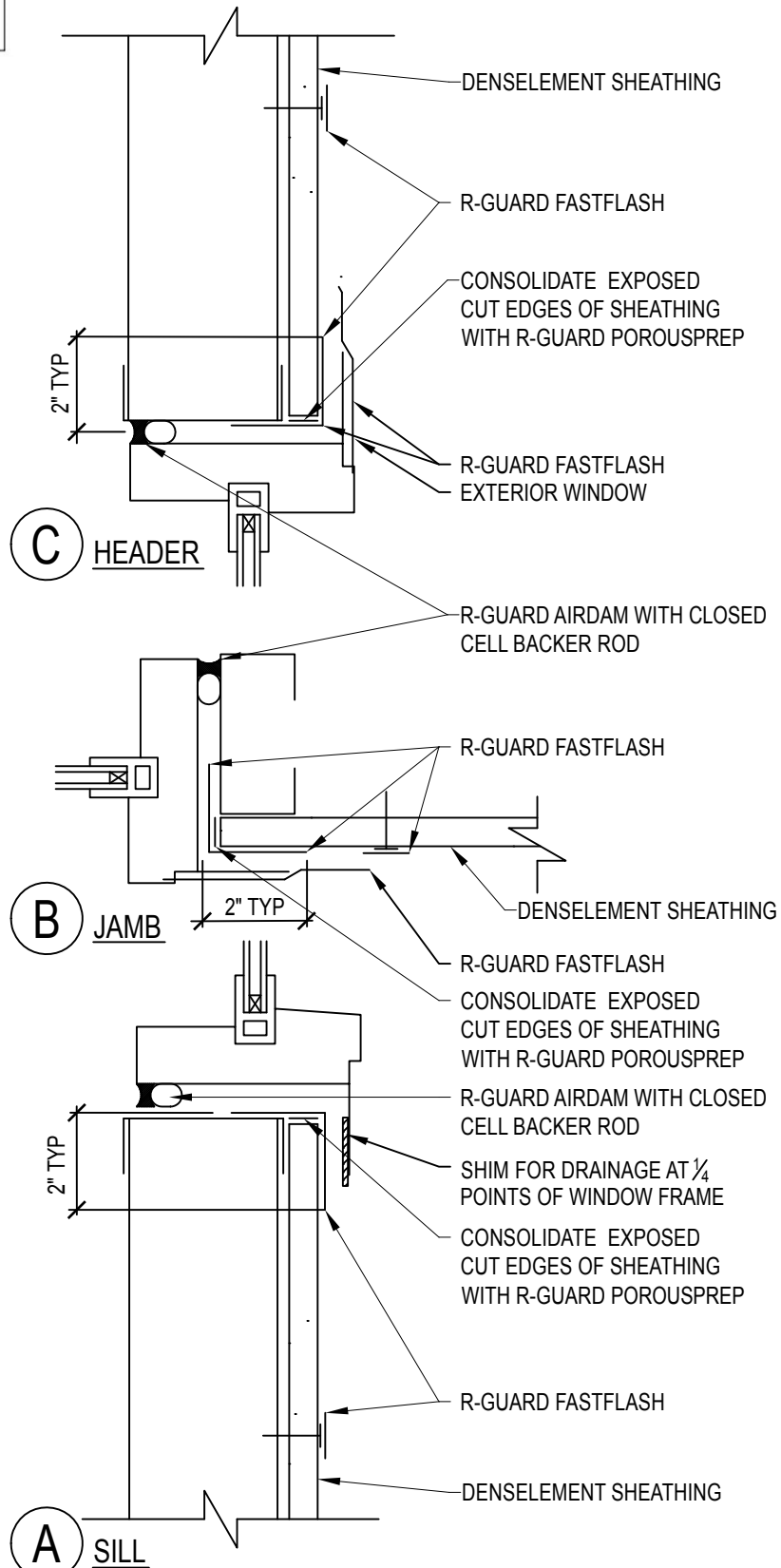

**NOTE:**  
 ADEQUATE DRAINAGE NEEDS TO BE PROVIDED AT EACH WINDOW FRAME SILL FLANGE. R-GUARD FASTFLASH IS NOT TO BE INSTALLED / APPLIED OVER NAIL FLANGE AT SILL CONDITION. INSERT WINDOW SHIM AT 1/4 POINTS OF WINDOW FRAME

## X6.1 SEALING WINDOW FLANGE

SCALE: 3" = 1'-0"



# DensElement Barrier System Details